

Installation guide for LED lighting bollards with 3p-Technology

See the assembly instruction for fitting the ground sleeve: "Ground shell 300/500 - Assembly instructions for bollards and other products with 3p-Technology"

1 INSTALL THE SPIRAL CABLE

→ Power connection must be established beforehand!

Connect permanently the spiral cable to the crimp connectors and the thermoretractable sleeve

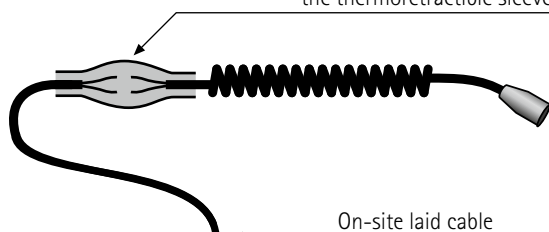

electricity supply/bollard:

supply voltage 24 V =
curr. consumption approx. 100 mA =
power consumption approx. 2,4 W

2 ATTACH THE CABLE

→ Cable must remain flexible!

Insert the cable of the bollard into the groove

Attach the cable loosely with wire ties

Close the connection plug

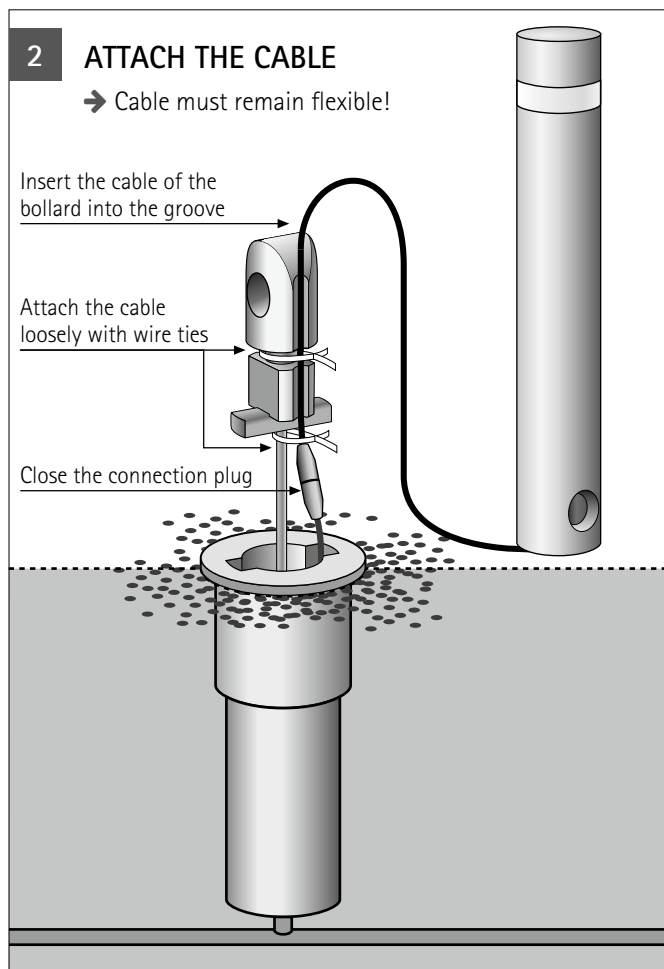

3 INSERT THE JUNCTION PIECE

→ Protect the cable against damage!

Insert the junction piece and rotate it by 180°

Push the cable as far as possible into the ground socket

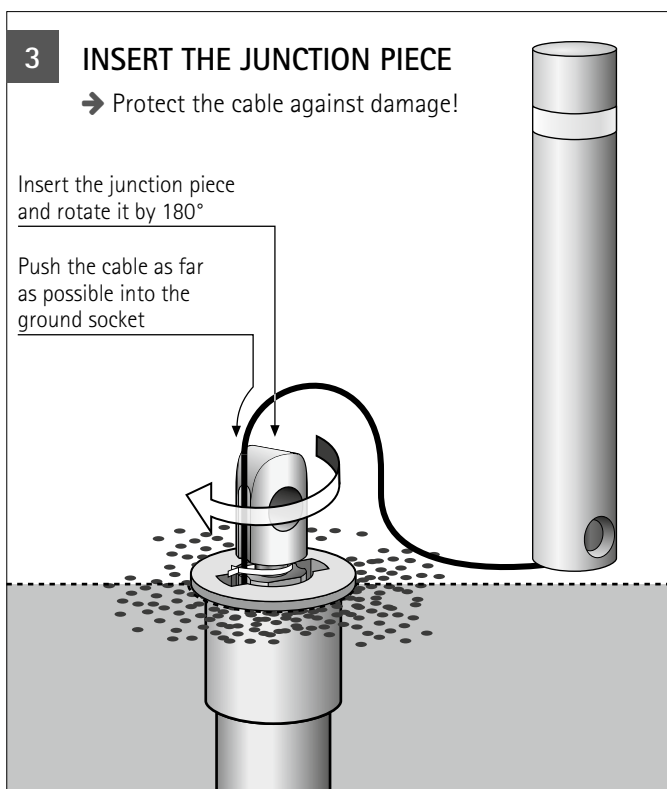

4 INSTALL AND FIX THE BOLLARD

→ Protect the cable against damage!

Install the bollard while protecting the cable against damage

Screw firmly the bollard with a clamping cone set

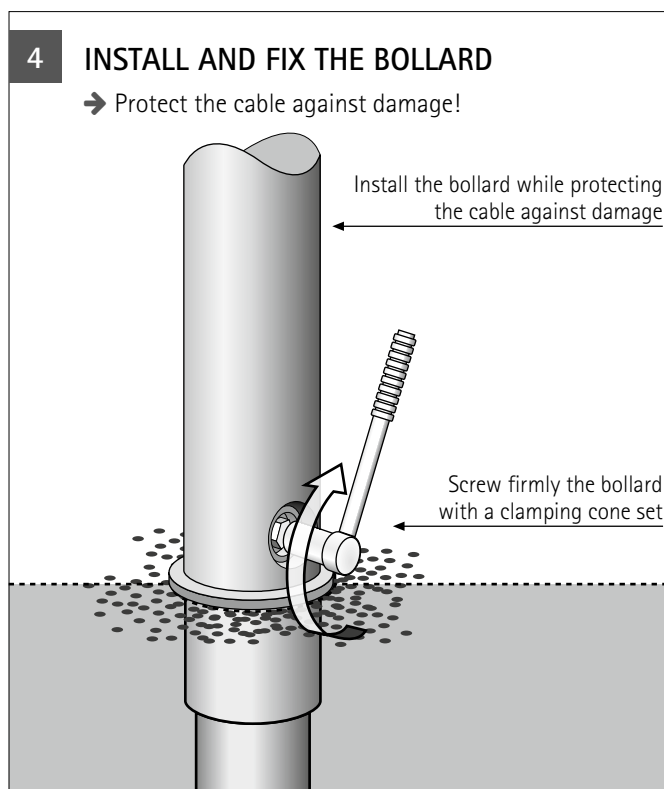

05/2017

Assembly instructions for bollards and other products with 3p-Technology

1 SETTING THE GROUND SHELL IN CONCRETE

- Dig a square hole for the base
- **Size depends on soil quality ▲**
- Make provisions for a water drain in the base
- Lay the ground shell flush with the ground
- Position the ground shell horizontally
- Align the notches in the surface of the ground shells

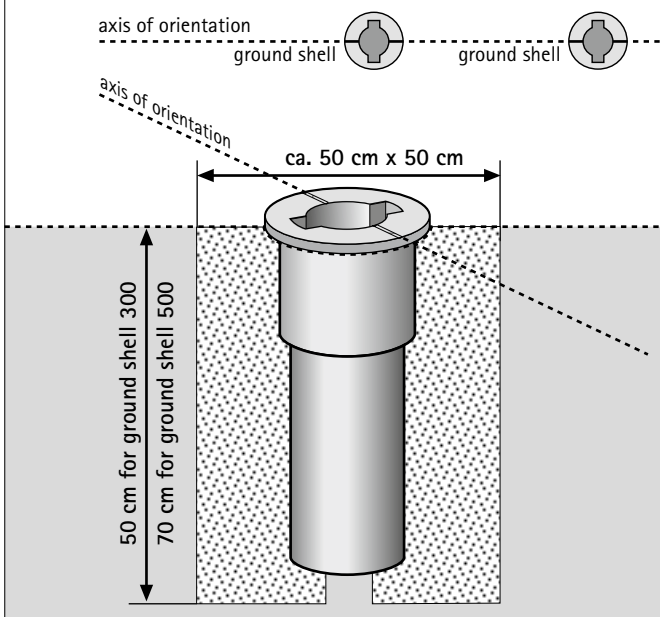

2 INSERTING THE JUNCTION PIECE

- Insert the junction piece into the ground shell
- Rotate the junction piece in the groove by 90° (no block)

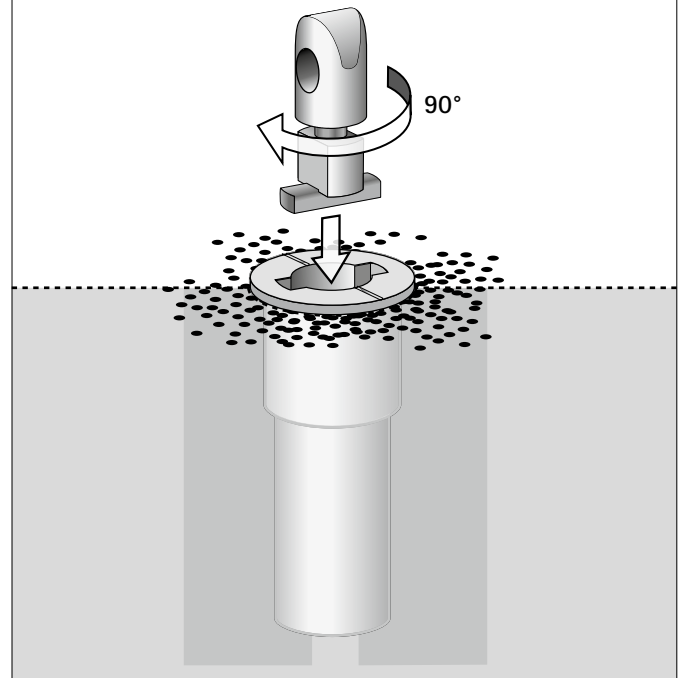

3 ASSEMBLING THE BOLLARD

- Place the bollard on the junction piece
- Align the holes in the bollard and junction piece with one another

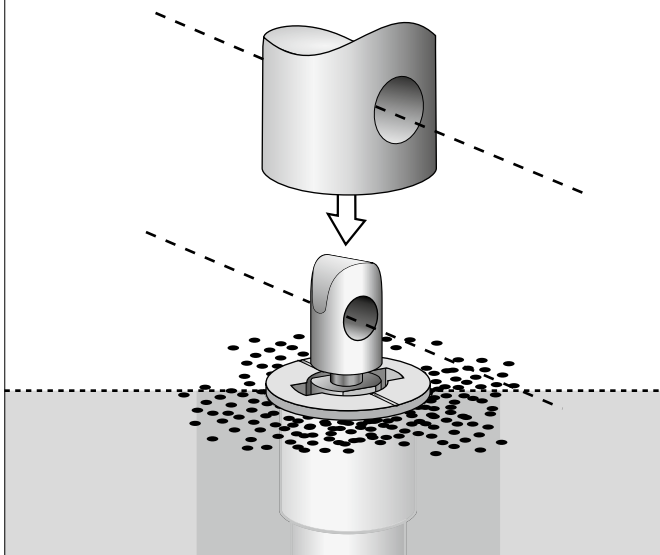

4 FASTENING THE BOLLARD

- Insert the clamping cone set provided (triangular or hexagonal head screws)
- Screw bollard tightly

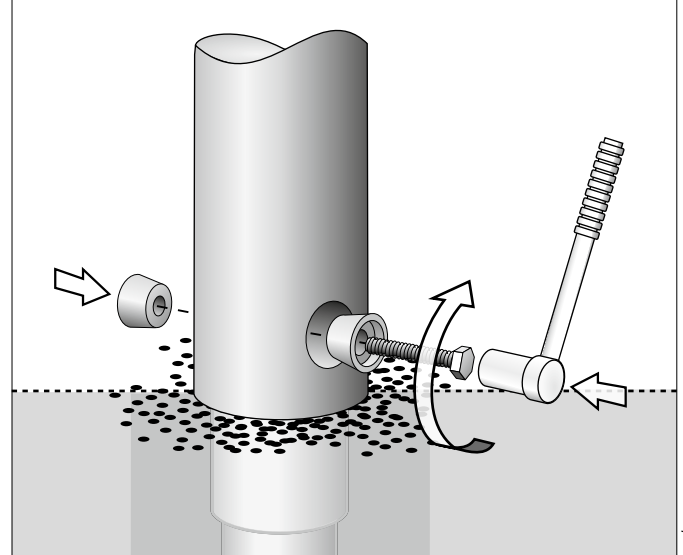

05/2017