

Dismantling bollards without separating the individual parts

1 LOOSEN CLAMPING BOLT

- Only loosen the screw in the clamping cone until the clamping cone set becomes loose
- If necessary, move the bollard around a bit so that firmly fixed parts can be loosened

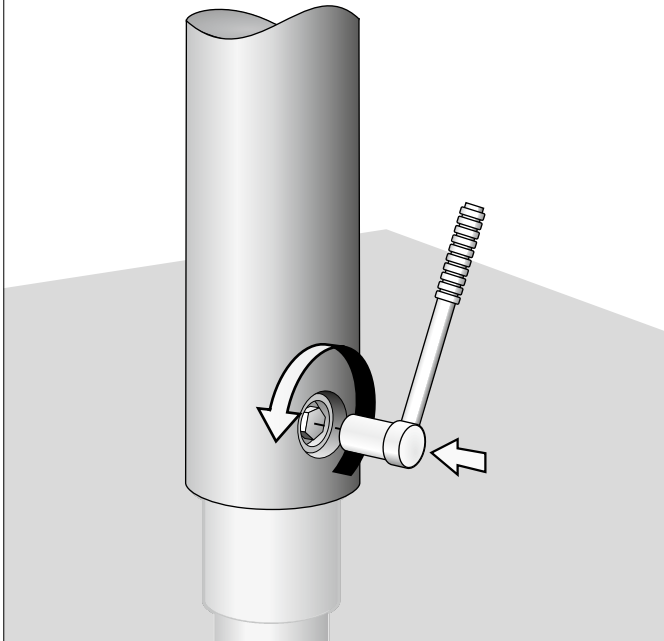

2 ROTATE BOLLARD WITH JUNCTION PIECE

- Rotate the bollard 90° and pull slightly upwards until it gives noticeably more

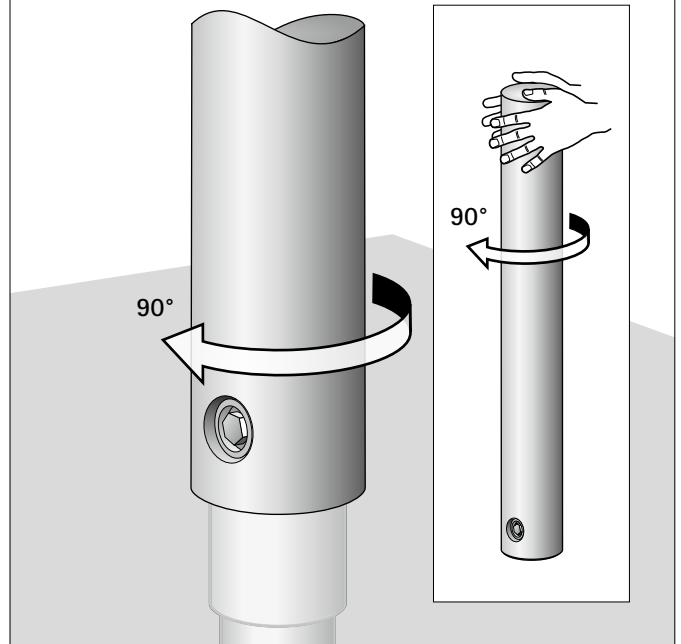

3 REMOVE BOLLARD WITH JUNCTION PIECE

- Lift the bollard and junction piece out of the ground shell

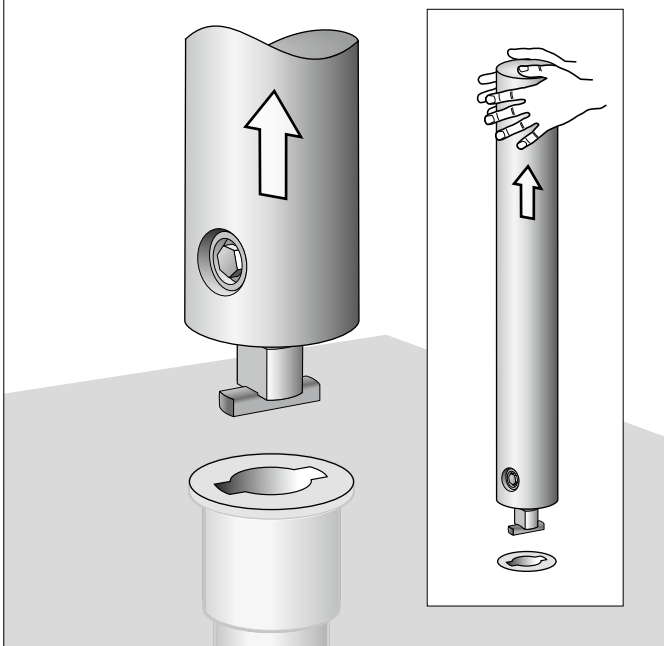

4 REASSEMBLE GROUND SHELL COVER OR BOLLARD

- Insert the ground shell cover into the ground shell's groove and press down
- Or reassemble the bollard with junction piece in reverse order

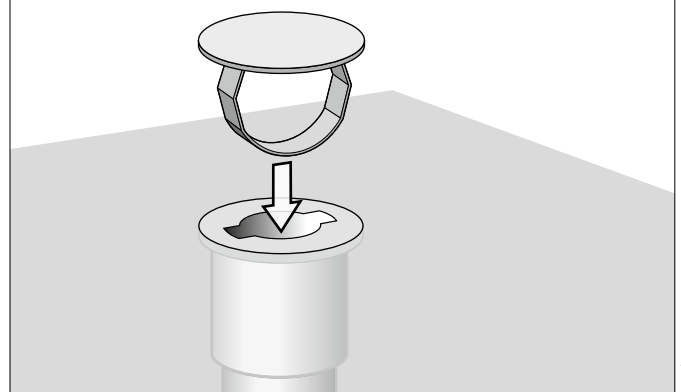

06/2023