

Assembly instructions for bollards and other products with 3p-Technology

1 SETTING THE GROUND SHELL IN CONCRETE

- Dig a square hole for the base
- **Size depends on soil quality** ⚠
- Make provisions for a water drain in the base
- Lay the ground shell flush with the ground
- Position the ground shell horizontally
- Align the notches in the surface of the ground shells

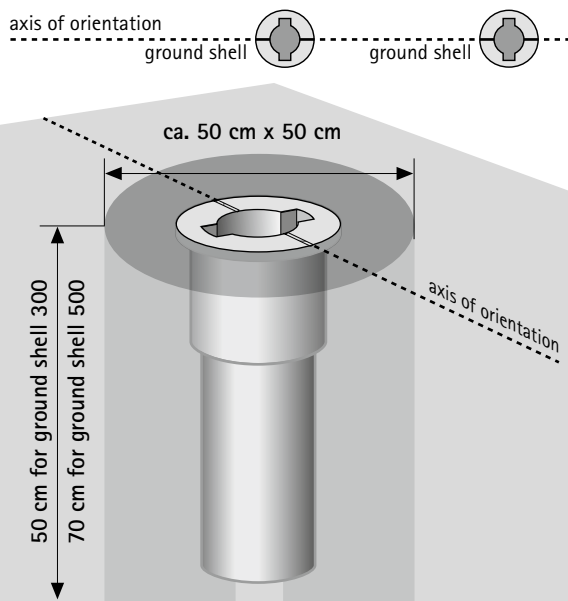

2 INSERTING THE JUNCTION PIECE

- Insert the junction piece into the ground shell
- Rotate the junction piece in the groove by 90° (no block)

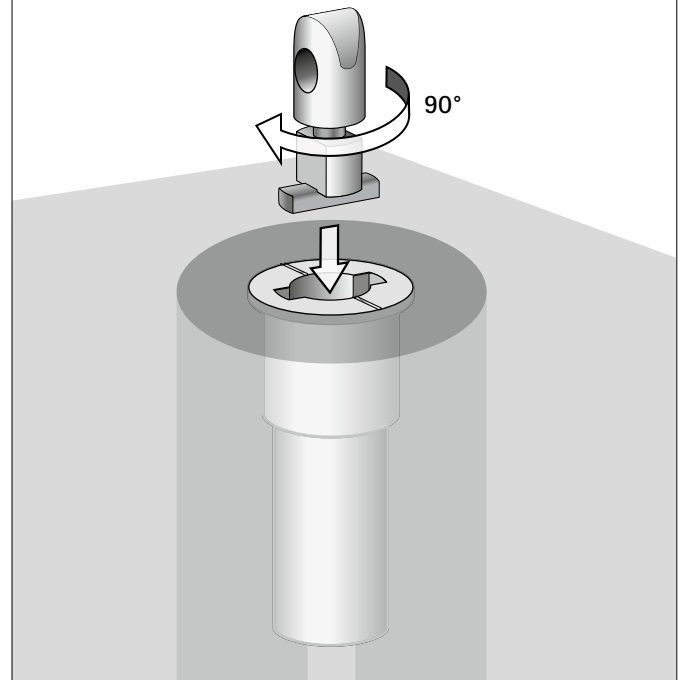

3 ASSEMBLING THE BOLLARD

- Place the bollard on the junction piece
- Align the holes in the bollard and junction piece with one another

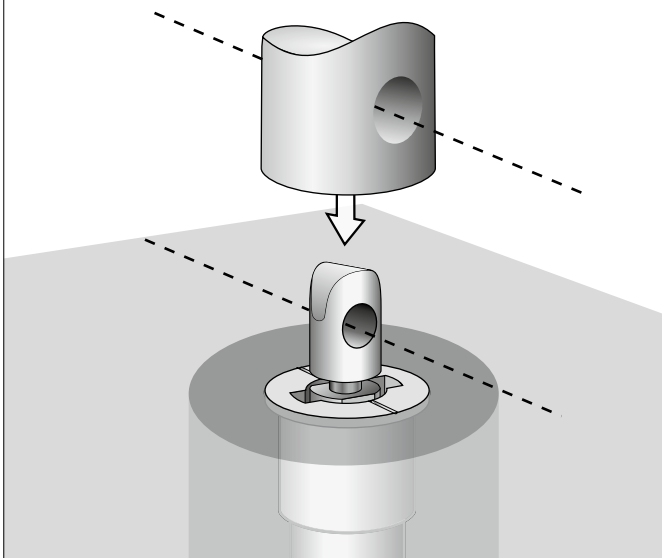

4 FASTENING THE BOLLARD

- Insert the clamping cone set provided (triangular or hexagonal head screws)
- Screw bollard tightly

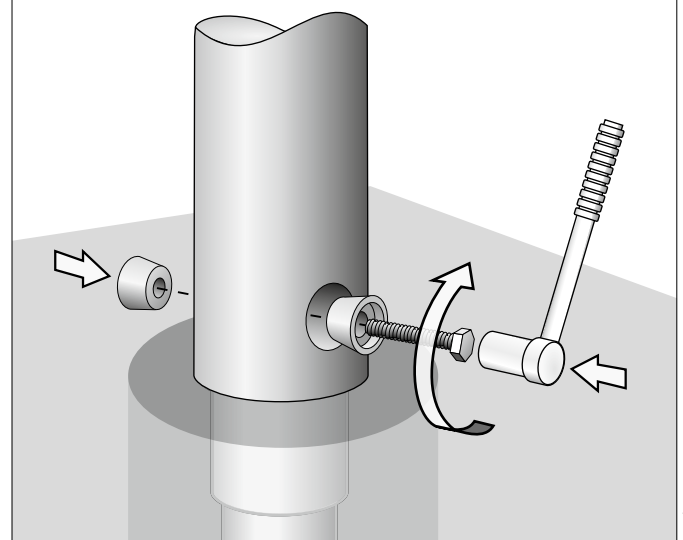

06/2023

Dismantling bollards without separating the individual parts

1 LOOSEN CLAMPING BOLT

- Only loosen the screw in the clamping cone until the clamping cone set becomes loose
- If necessary, move the bollard around a bit so that firmly fixed parts can be loosened

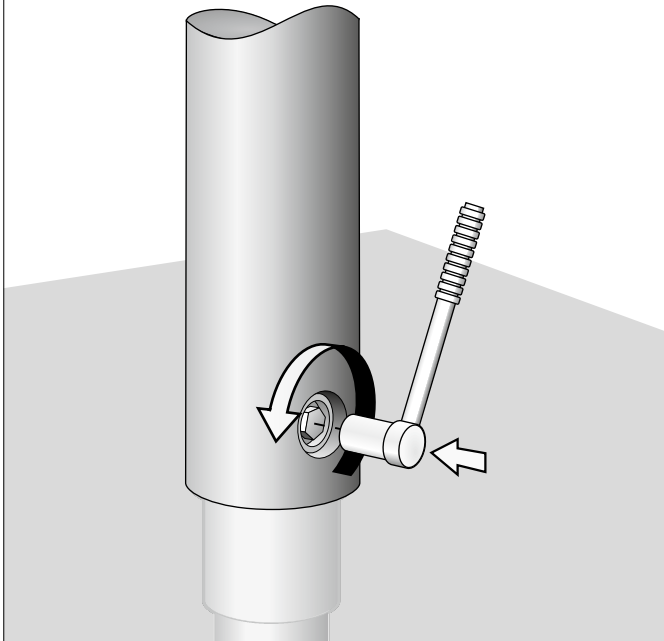

2 ROTATE BOLLARD WITH JUNCTION PIECE

- Rotate the bollard 90° and pull slightly upwards until it gives noticeably more

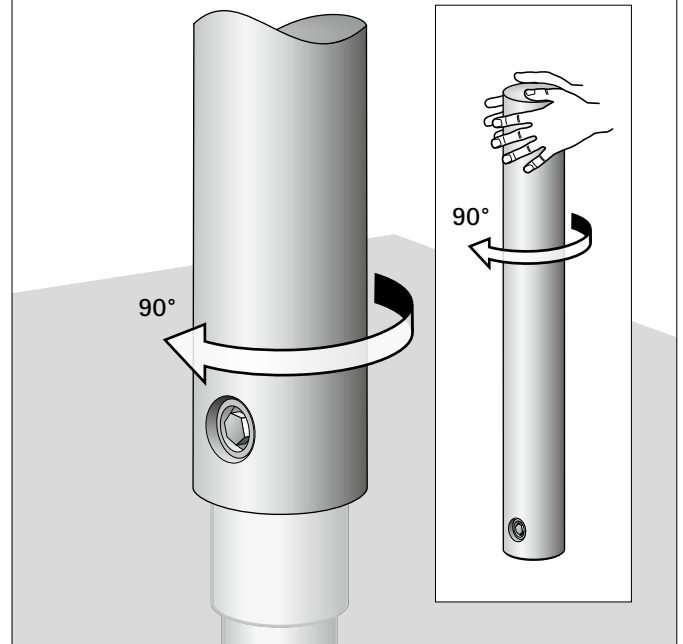

3 REMOVE BOLLARD WITH JUNCTION PIECE

- Lift the bollard and junction piece out of the ground shell

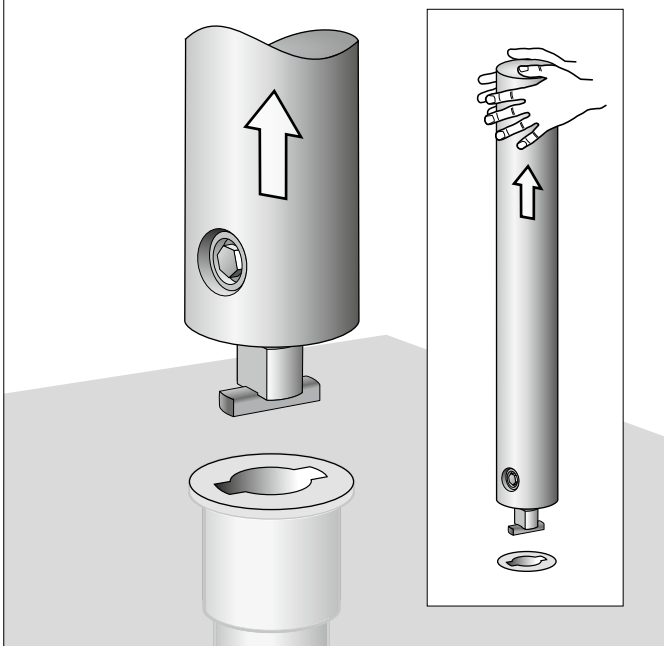

4 REASSEMBLE GROUND SHELL COVER OR BOLLARD

- Insert the ground shell cover into the ground shell's groove and press down
- Or reassemble the bollard with junction piece in reverse order

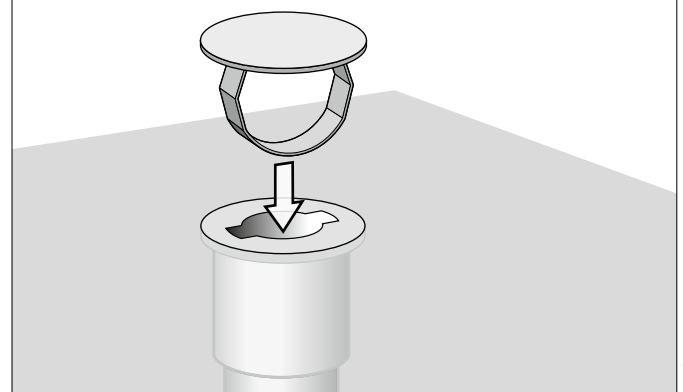

06/2023